

## 20' Clear Vinyl Tubing

### Installation Instructions

1. Attach 3/8" diameter, 20' Clear Vinyl Tubing to the outlet barb of your SimpleAir® A/C Condensate Pump.
2. Secure with a 1/2" hose clamp (not included).
3. Route the tubing up and away from the unit to the building's exterior or other drain location. Avoid compressing or kinking the tubing.

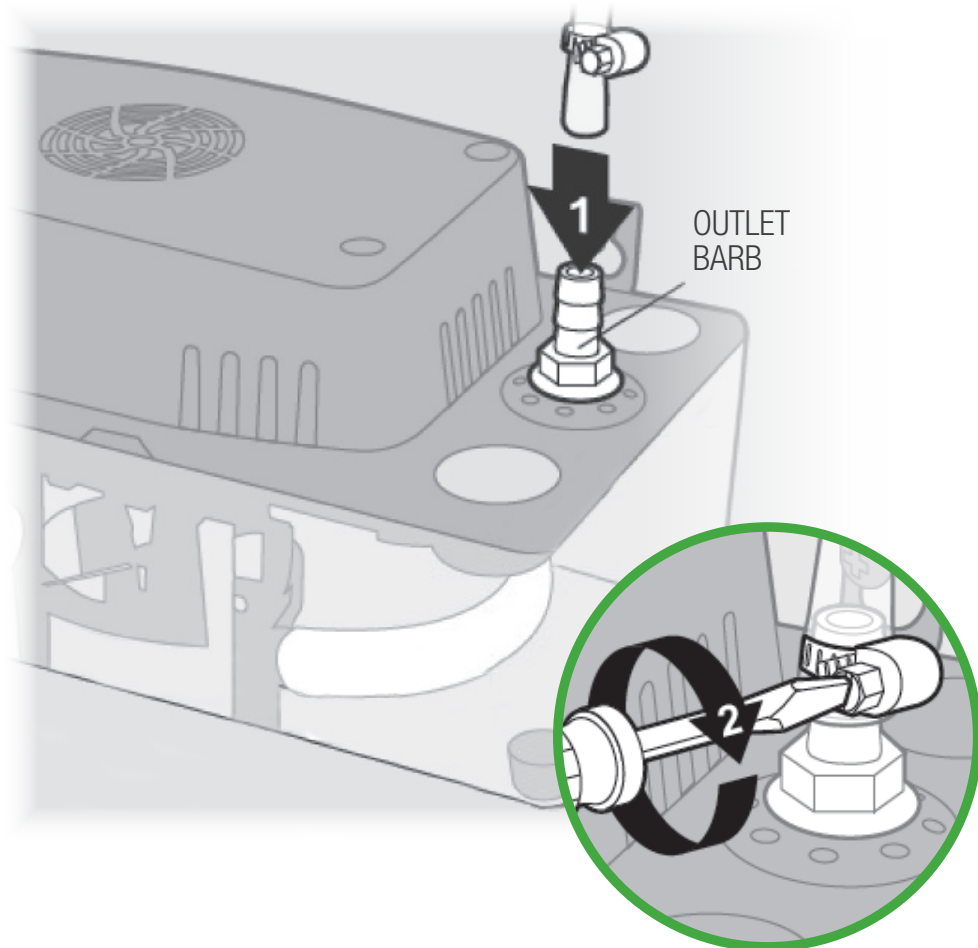

**NOTE:** The tube route should be the shortest possible distance from the pump to the building exterior or drain location. For best results, the distance that the water must go UP should be shorter than the distance that it goes DOWN.

**MANUFACTURED FOR:**  
SimpleAir Care, LLC  
P.O. Box 357  
Columbus, TX 78934  
855.342.3732  
[SimpleAirCare.com](http://SimpleAirCare.com)