

A/C Condensate Pump

Installation Instructions

Before beginning installation, locate power outlet and determine inlet for PVC drain line and clear vinyl tubing to orient pump for proper connection.

1. Mount the pump on the side of the air handler, furnace, wall or on the floor.
2. Install 3/8" clear vinyl plastic tubing to the outlet barb and secure with a 1/2" hose clamp.
3. Insert PVC condensate drain tubing into appropriate inlet hole.
4. Connect the safety switch. (If the pre-existing pump used a safety switch, then reconnect. Not required if safety switch was not used previously.)
5. Plug pump into a properly grounded 3-prong, 120-volt ground fault circuit interrupter (GFCI) outlet.
6. Test pump by manually moving the float before using to ensure proper installation and function.

MATERIALS NEEDED

- Screwdriver
- 1/2" hose clamp
- Bucket for disposal of reservoir water
- Level
- Tape measure
- Safety glasses

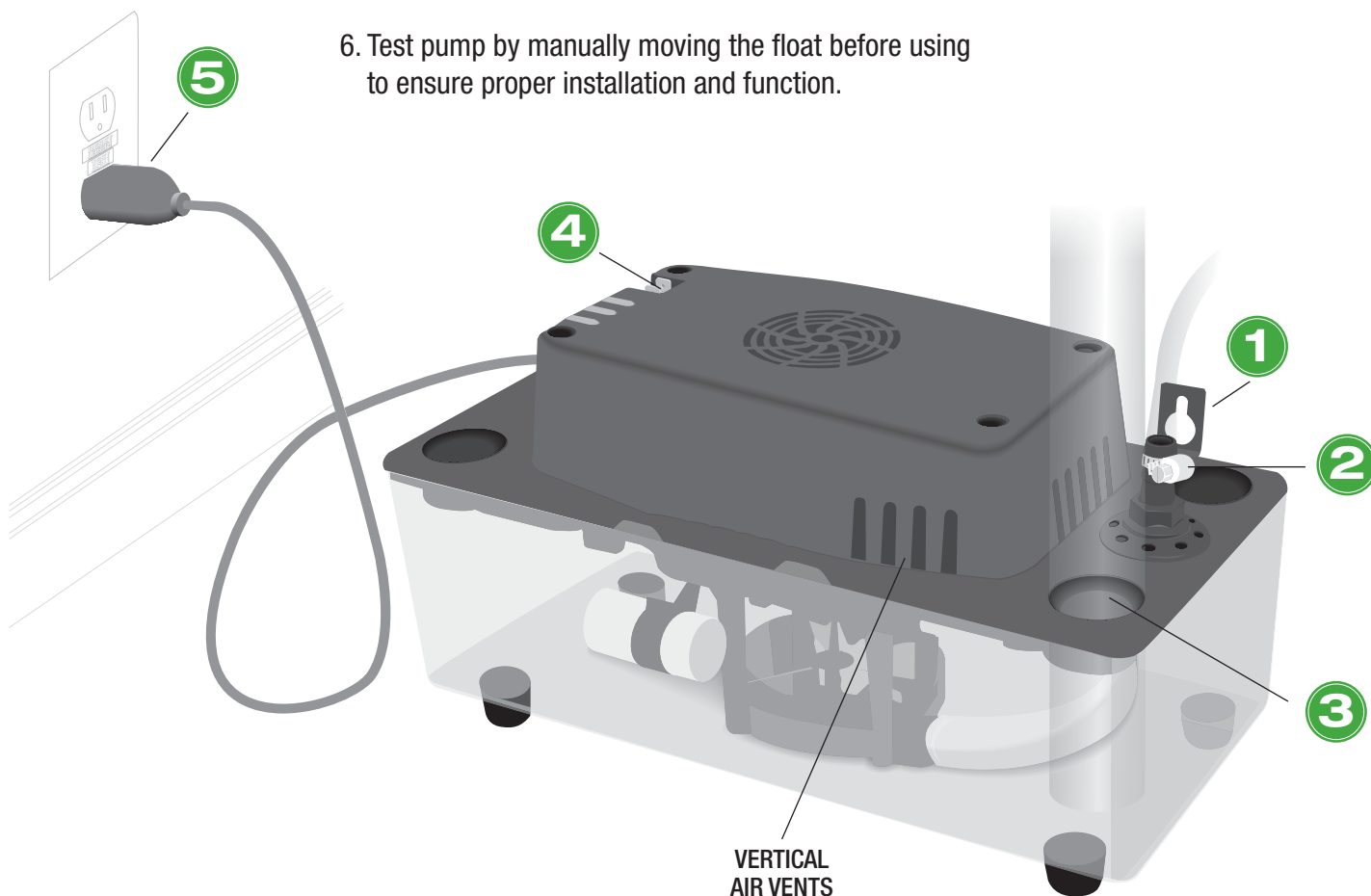

CAUTION: Do not cover the vertical air vents located on the top or sides of the pump housing. The pump is air-cooled and may be operated continuously as long as the vertical air vents remain uncovered.

MANUFACTURED FOR:
SimpleAir Care, LLC
P.O. Box 357
Columbus, TX 78934
855.342.3732
SimpleAirCare.com